

Monitorix[®] connector

TECHNICAL DATA SHEET

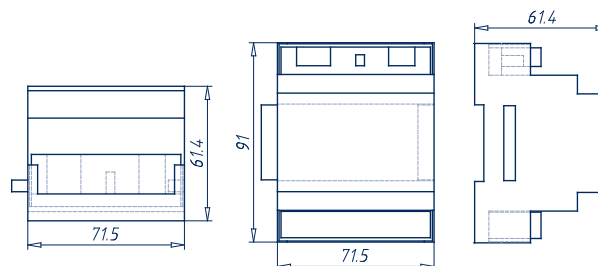

Mechanical properties

dimensions 71.5 x 91 x 61.4 mm (On top-hat rail 4DU*)

weight 115 g

* DU = dividing unit (18 mm)

Electrical properties

supply voltage +12V ± 30 % (reverse polarity protected)

Bus interface CAN, LIN, extension

CE conformity

Connecting the electronics Serial connection

power supply processor unit LAN-module connector

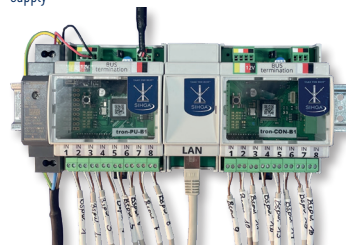

Connections

8x for sensor strips

1x LIN-Bus for up to 8 pcs. CORE or 8 pcs. DIGITAL sensor (mix possible)

1x CAN-Bus power supply, connection for max. 13 connectors

2x extension plugs
1x plug connection (male) to Monitorix LAN-module or other connectors
1x plug connection (female) to other connectors

Connecting the electronics BUS connection

power supply processor unit LAN-module connector

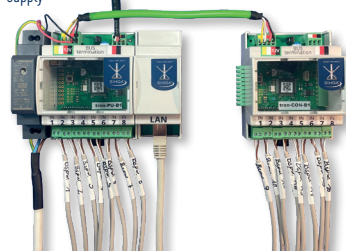

Sensors

amount 8

measuring range 100 Ω ... 30 MΩ 0 ... 65535 Units

accuracy ± 1 % ± 1 %

resolution 0.1 % ± 1 Unit

measurement method resistive modified impedance

Ambient conditions

storage 10 ... 30 °C / 40 ... 60 % RH

operation 0 ... +70 °C / 10 ... 90 % RH (non-condensing)

TAKE THE BEST



Leitbetrieb Leitbetrieb
Österreich Deutschland

FUNCTION

The connector tron-CON is a measuring device that transmits data to the processor unit tron-PU via CAN bus. The sensor measurements are converted into digital values by the connector tron-CON.

The guidelines for sensor installation and cable lengths are listed in the installation instructions.

NOTES ON THE APPLICABILITY AND VALIDITY OF THE DATA SHEET

All information is intended for professionals such as architects, building planners, tradesmen in the construction / roofing, carpentry and gardening and landscaping trades. They do not release you from your own responsibility. They have been compiled to the best of our knowledge, but do not constitute a guarantee. The currently applicable standards and recognised rules of technology apply to all planning and execution. We reserve the right to make changes due to improvements in application or production technology. The contents of the data sheet do not replace object-related, specialised structural planning. Interfaces to neighbouring trades are not highlighted separately, but must nevertheless be taken into account during planning and execution.

IMPORTANT NOTE: Please ensure that the sensors and sensor tracks are installed when dry!

TAKE THE BEST



Leitbetrieb Österreich Leitbetrieb Deutschland